

Labor-Quarzglas

Laboratory Quartz glass



DIN 12242
Kegelschliffe · Standard Ground Joints
Cone and Socket

DIN 12244
Kugelschliffe · Ball and Socket Joints

DIN 12216
Normgewinde · Standardized Screw Threads

DIN 28403
Vakuum-Kleinflansche · Vacuum Flanges

DIN 12542
Hähne · Stopcocks

DIN 12330
Bechergläser · Beakers

DIN 12395
Reagenzgläser · Test Tubes

DIN 51720
DIN 51740
DIN 12904
Tiegel · Crucibles

DIN 12353
Rundkolben · Round Bottom Flasks

DIN 12353
Stehkolben · Flat Bottom Flasks

DIN 12353
Erlenmeyerkolben · Erlenmeyer Flasks

DIN 12360
Kjeldahlkolben · Kjeldahl flasks

DIN 12341
Uhrglas-Schalen · Watch Glass Capsules

DIN 12336
Abdampfschalen · Evaporating Basins

DIN 12337
DIN 12338
Kristallisierungsschalen · Crystallizing Dishes

DIN 12339
Petrischalen · Petri dishes

Verbrennungsschiffchen · Combustion Boats

Verbrennungsrohre · Combustion Tubes

Kühler · Condenser

Normschliffe Standard Joints

NS-Kegelschliffe (DIN 12242) · Standard Ground Joints (DIN 12242)

NS NS	Kern Cone			Hülse Socket		
	Rohr A Ø Tube O Ø	Gesamt- länge Overall length	Ident-Nr. Item-no.	Rohr A Ø Tube O Ø	Gesamt- länge Overall length	Ident-Nr. Item-no.
5/13	4	120	9786970	8	120	9786971
7/16	6	120	9786972	10	120	9786973
10/19	8	120	9786974	13	120	9786975
12/21	11	120	9786976	15	120	9786977
14/23	13	120	9786978	17	120	9786979
19/26	17	120	9786980	22	125	9786981
24/29	22	150	9786982	28	135	9786983
29/32	26	150	9786984	34	135	9786985
34/35	30	150	9786986	40	150	9786987
45/40	40	150	9786988	50	150	9786989
60/45	55	180	9786990	65	180	9786991
71/51	65	200	9786992	75	200	9786993
85/55	80	200	9786994	90	200	9786995
100/60	95	200	9786996	105	200	9786997
110/60	105	200	9786998	105	200	9786999
115/60	110	200	9786700	120	200	9786701
120/60	115	200	9787002	125	200	9787003
125/60	120	200	9787004	130	200	9787005
130/60	125	200	9787006	135	200	9787007
135/60	130	200	9787008	140	250	9787009
145/60	140	200	9787010	150	250	9787011
150/60	145	200	9787012	155	200	9787013

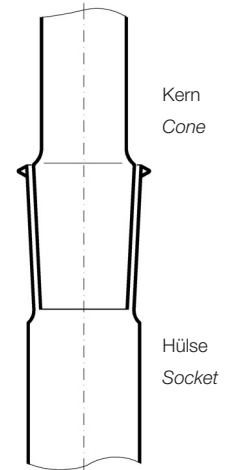

Kugelschliffe (DIN 12244) · Ball and Socket Joints (DIN 12244)

	Schale (Form A) Socket (Form A)		Ident-Nr. Item-no.	Kugel (Form B) Ball (Form B)	Kugel (Form B) Ball (Form B)
	Rohr Tube	Gesamt- länge Overall length		Ident-Nr. Item-no. hohl hollow	Ident-Nr. Item-no. massiv massive
S13	8 x 1,9	100	9786653	9786652	9786652-M
S19	13 x 2	100	9786655	9786654	9786654-M
S29	19 x 2	120	9786657	9786656	9786656-M
S35	25 x 2,5	120	9786659	9786658	9786658-M
S40	30 x 2,2	150	9786661	9786660	9786660-M
S41	30 x 2,5	150	9786663	9786662	9786662-M
S51	36 x 2,2	150	9786665	9786664	9786664-M
S64	48 x 2,4	150	9786667	9786666	
S76	58 x 3,4	150	9786669	9786668	
S102	82 x 3,4	150	9786671	9786670	

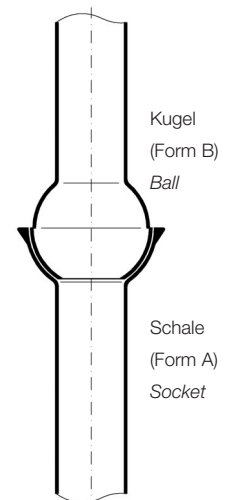

Normgewinde Screw Threads

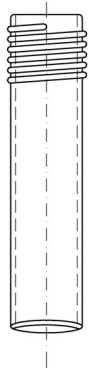

Normgewinde an Quarzglasrohren (DIN 12216, Form E) Standardized Screw Threads on clear and opaque fused Quartz Tubes (DIN 12216, Form E)

Größe Size	Rohr \varnothing mm Tube \varnothing mm	Dicke mm Thickness mm	Ident-Nr. transparent Item-no.	Ident-Nr. opaque Item-no.
GL 14	12	1,4	9787301	9787301-O
GL 18	16	2	9787302	9787302-O
GL 25	22	2	9787303	9787303-O
GL 32	28	2,2	9787304	
GL 45	42	2,4	9787305	

Vakuum-Kleinflansche (DIN 28403) transparent und opaque Vacuum Flanges (DIN 28403) transparent and opaque

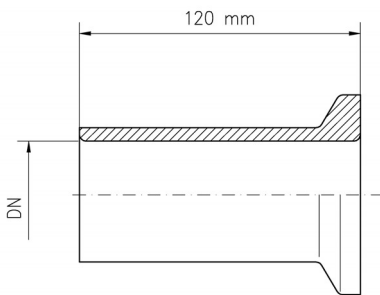

DN	Ident-Nr. Item-no. transparent	Ident-Nr. Item-no. opaque
DN 10	9780010	9780010-O
DN 16	9780016	9780016-O
DN 25	9780025	9780025-O
DN 40	9780040	9780040-O
DN 50	9780050	9780050-O

Sonderflasche auf Anfrage. Flaschenlänge transparent 120 mm, opaque 40-55 mm.
Special Flanges on request. Flange length opaque 40-55 mm.

Einweghähne (DIN 12542) One-Way Stopcocks (DIN 12542)

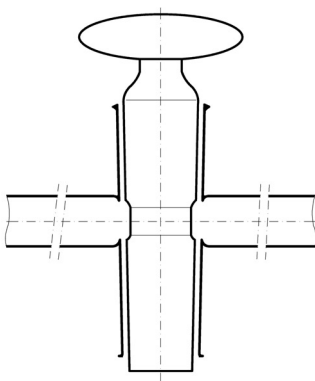

Nenngröße Reference No.	Bohrung mm Bore mm	Ident-Nr. Item-no.
2	1,5	9786560
3	2,5	9786561
4	4	9786562
6	6	9786563
10	10	9786565

Dreiweghähne sowie Sonderausführungen auf Anfrage.
Three-way Stopcocks and special Stopcocks on request.

Becher/ Reagenzgläser/ Tiegel Beakers/ Test Tubes/ Crucibles

Bechergläser mit Ausguss (DIN 12330) · Beakers with Spout (DIN 12330)

niedrige Form <i>low form</i>				hohe Form <i>tall form</i>			
ml	Ø mm	H mm	Ident-Nr. <i>Item-no.</i>	ml	Ø mm	H mm	Ident-Nr. <i>Item-no.</i>
5	21	29	9785250	25	30	55	9785204
10	25	35	9785251	50	38	65	9785205
25	32	47	9785254	100	45	80	9785206
50	39	55	9785255	150	52	97	9785207
100	49	70	9785256	250	60	115	9785209
150	55	80	9785257	400	70	130	9785211
250	69	90	9785259	600	78	145	9785213
400	80	100	9785261	800	86	170	9785214
600	90	115	9785263	1000	95	185	9785215
800	98	135	9785264	2000	115	235	9785217
1000	105	145	9785265	3000	135	280	9785219
2000	130	185	9785267	-	-	-	-
3000	155	210	9785269	-	-	-	-
5000	170	270	9785271	-	-	-	-

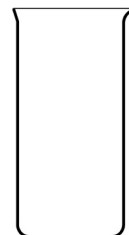
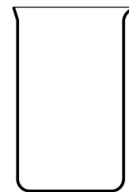

Sonderabmessung auf
Anfrage.
*Special dimensions on
request.*

Reagenzgläser (DIN 12395) · Test Tubes (DIN 12395)

Ø mm	Länge (mm) <i>Length (mm)</i>	Ident-Nr. <i>Item-no.</i>
8	70	9785300
10	100	9785301
12	100	9785302
14	130	9785303
16	160	9785304
18	180	9785305
20	180	9785306
30	200	9785307
40	200	9785308



Tiegel (DIN 51720 / DIN 51740 / DIN 12904) Crucibles (DIN 51720 / DIN 51740 / DIN 12904)

	Ø mm	Höhe mm <i>Height mm</i>	Gewicht <i>Weight</i>	Ident-Nr. Tiegel <i>Item-no. Crucible</i>	Ident-Nr. Deckel <i>Item-no. Lid</i>
Dr. Rademacher	27	45	27-29	9783250	9783251
ISO DIN 51720	25	38	10-14	9783260	9783261
Swelling Test DIN 51741	41	26	10-12,75	9783270	9783271

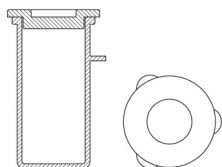

Form R

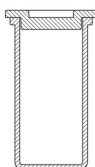

Form I

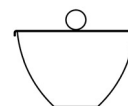

Form S

Tiegel (DIN 51720 / DIN 51740 / DIN 12904)
Crucibles (DIN 51720 / DIN 51740 / DIN 12904)

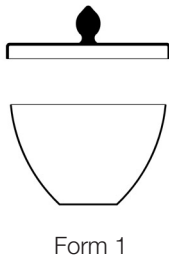

Tiegel DIN 12904 Crucible DIN 12904				Tiegeldeckel DIN 12904 Crucible Lid DIN 12904	
ml	Ø mm	Höhe mm Height mm	Ident-Nr. Item-no.	Ø mm	Ident-Nr. Item-no.
6	30	19	9783300	34	9783330
11	35	22	9783301	39	9783331
15	40	25	9783302	44	9783332
25	45	28	9783303	49	9783333
29	50	32	9783304	54	9783334
50	60	38	9783305	64	9783335
85	70	44	9783306	74	9783336

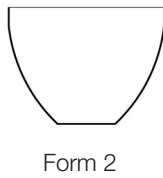

Tiegel DIN 12904 Crucible DIN 12904				Tiegeldeckel DIN 12904 Crucible Lid DIN 12904	
ml	Ø mm	Höhe mm Height mm	Ident-Nr. Item-no.	Ø mm	Ident-Nr. Item-no.
15	35	28	9783307	39	9783331
20	40	32	9783308	44	9783332
38	45	36	9783309	49	9783333
49	50	40	9783310	54	9783334
90	60	48	9783311	64	9783335
150	70	56	9783312	74	9783336

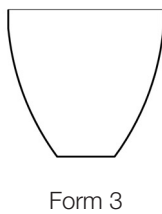

Tiegel DIN 12904 Crucible DIN 12904				Tiegeldeckel DIN 12904 Crucible Lid DIN 12904	
ml	Ø mm	Höhe mm Height mm	Ident-Nr. Item-no.	Ø mm	Ident-Nr. Item-no.
15	30	38	9783313	34	9783330
24	35	44	9783314	39	9783331
40	40	50	9783315	44	9783332
50	45	56	9783316	49	9783333
75	50	62	9783317	54	9783334
120	60	75	9783318	64	9783335

Kolben Flasks

Rundkolben (DIN 12353) · Round Bottom Flasks (DIN 12353)

enghalsig · narrow neck

ml	Ø mm	D mm	H mm	Ohne NS Ident-Nr. <i>Without socket Item-no.</i>	mit NS <i>With socket</i>	Ident-Nr. <i>Item-no.</i>
50	51	22	105	9782000	14	9782006
100	64	22	115	9782001	19	9782007
250	85	34	145	9782002	29	9782008
500	105	34	175	9782003	29	9782009
1000	131	42	210	9782004	29	9782010
2000	165	50	260	9782005	29	9782011

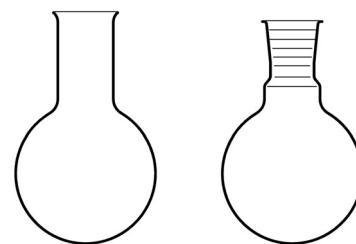

weithalsig · wide neck

ml	Ø mm	D mm	H mm	Ohne NS Ident-Nr. <i>Without socket Item-no.</i>	mit NS <i>With socket</i>	Ident-Nr. <i>Item-no.</i>
50	51	34	105	9782012	29	9782018
100	64	34	115	9782013	29	9782019
250	85	50	145	9782014	45	9782020
500	105	50	175	9782015	45	9782021
1000	131	65	210	9782016	45	9782022
2000	165	76	260	9782017	45	9782023

Stehkolben (DIN 12353) · Flat Bottom Flasks (DIN 12353)

enghalsig · narrow neck

ml	Ø mm	D mm	H mm	Ohne NS Ident-Nr. <i>Without socket Item-no.</i>	mit NS <i>With socket</i>	Ident-Nr. <i>Item-no.</i>
50	51	22	100	9782024	19	9782030
100	64	22	110	9782025	19	9782031
250	85	34	140	9782026	29	9782032
500	105	34	170	9782027	29	9782033
1000	131	42	200	9782028	29	9782034
2000	165	50	250	9782029	29	9782035

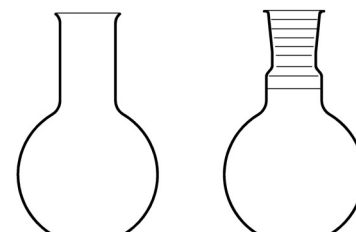

weithalsig · wide neck

ml	Ø mm	D mm	H mm	Ohne NS Ident-Nr. <i>Without socket Item-no.</i>	mit NS <i>With socket</i>	Ident-Nr. <i>Item-no.</i>
50	51	34	100	9782036	29	9782042
100	64	34	100	9782037	29	9782043
250	85	50	140	9782038	45	9782044
500	105	50	170	9782039	45	9782045
1000	131	65	200	9782040	45	9782046
2000	165	76	250	9782041	45	9782047

Erlenmeyerkolben (DIN 12353) · Erlenmeyer Flasks (DIN 12353)

enghalsig · narrow neck

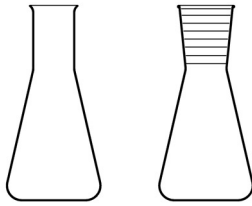

ml	Ø mm	H mm	Ohne NS Ident-Nr. <i>Without socket Item-no.</i>	mit NS <i>With socket</i>	Ident-Nr. <i>Item-no.</i>
25	42	70	9782050	19	9782057
50	54	80	9782051	19	9782058
100	65	105	9782052	19	9782059
250	85	140	9782053	29	9782060
500	105	175	9782054	29	9782061
1000	134	210	9782055	29	9782062
2000	166	280	9701034	-	-
3000	185	315	9782056	45	9782063

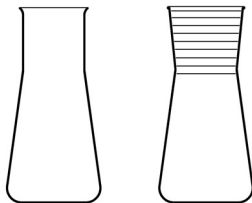

weithalsig · wide neck

ml	Ø mm	H mm	Ohne NS Ident-Nr. <i>Without socket Item-no.</i>	mit NS <i>With socket</i>	Ident-Nr. <i>Item-no.</i>
50	51	80	9782064	29	9782069
100	64	105	9782065	29	9782070
250	85	140	9782066	45	9782071
500	105	175	9782067	45	9782072
1000	130	210	9782068	45	9782073
2000	153	275	9782074	45	-

Kjeldahlkolben mit Schliff (DIN 12360)

Kjeldahl with cut (DIN 12360)

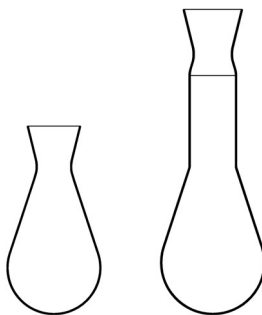

ml	d1 mm	d2 mm	H mm	mit NS <i>With socket</i>	Ident-Nr. <i>Item-no.</i>	Ident-Nr. <i>Item-no.</i>
50	51	22	200	19/26	9782110	-
50	51	22	200	-	-	9782101
100	60	22	200	19/26	9782111	-
100	60	22	200	-	-	9782102
250	81	34	270	29/32	9782112	-
250	81	34	270	-	-	9782103
500	101	34	300	29/32	9782113	-
500	101	34	300	-	-	9782104
750	115	34	340	29/32	9782114	-
750	115	34	340	-	-	9782105
1000	126	34	350	29/32	9782115	-
1000	126	34	350	-	-	9782106

Schalen Capsules Basins

Uhrglas-Schalen (DIN 12341) Watch Glass Capsules (DIN 12341)

Ø mm	r mm	Ident-Nr. Item-no.
20	58	9784408
40	58	9784400
50	58	9784401
60	58	9784402
70	65	9784403
80	74	9784404
100	102	9784405
125	130	9784406
150	160	9784407



Abdampfschalen mit Ausguss (DIN 12336) Evaporating Basins with Spout (DIN 12336)

ml	Ø mm	H mm	Ident-Nr. Item-no.
10	40	18	9784100
15	50	25	9784101
45	60	30	9784102
60	70	35	9784103
90	80	45	9784104
170	95	55	9784105
320	115	65	9784106
600	140	80	9784107
1500	190	100	9784108

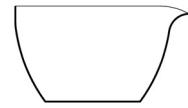

Kristallisierungsschalen (DIN 12 337/ DIN 12 338) Crystallizing Dishes (DIN 12 337/ DIN 12 338)

Inhalt ml Capacity ml	Ø mm	H mm	Ident-Nr. ohne Ausguss Item-no. without spout	Ident-Nr. mit Ausguss Item-no. with spout
20	40	25	9789024	9789033
40	50	30	9789025	9789034
60	60	35	9789026	9789035
100	70	40	9789027	9789036
150	80	45	9789028	9789037
300	95	55	9789029	9789038
400	100	60	9789030	9789039
500	115	65	9789031	9789040
900	140	75	9789032	9789041

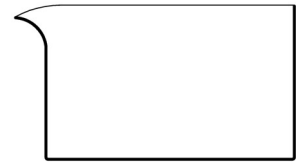

Petrerschalen (DIN 12339) · Culture (Petri) Dishes (DIN 12339)

Deckel Cover	d1 mm	h1 mm	Ident-Nr. Item-no.	Unterschale Base	d2 mm	h2 mm	Ident-Nr. Item-no.
20	20	6	9781151	15	15	8	9781164
25	25	6	9781152	20	20	8	9781165
30	30	6	9781153	25	25	8	9781166
35	35	6	9781154	30	30	8	9781167
40	40	12	9781155	35	35	15	9781168
45	45	12	9781156	40	40	15	9781169
50	50	12	9781157	45	45	20	9781170
60	60	12	9781158	55	55	20	9781171
70	70	12	9781159	65	65	20	9781172
80	80	12	9781160	75	75	20	9781173
90	90	12	9781161	85	85	20	9781174
100	100	12	9781162	95	95	20	9781175
120	120	12	9781163	115	115	20	9781176
150	150	20	9781177	140	140	30	9781178

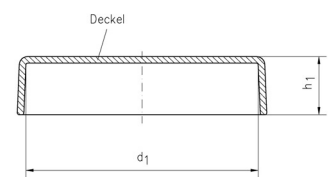

Petri-Schale Deckel
Petri dishes cover

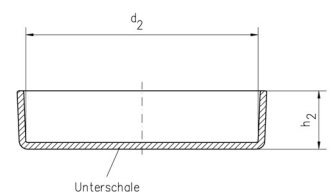

Petri-Schale Unterschale
Petri dishes base

Verbrennungsschiffchen Combustion Boats

Länge mm <i>length mm</i>	Breite mm <i>breadth mm</i>	Höhe mm <i>high mm</i>	Ident-Nr. <i>Item-no.</i>
25	5	4	9261540
48	15	10	9261541
77	16	9	9261542
78	19	11	9261543
103	21	14	9261544
154	34	17	9261545
200	26	20	9261546
250	26	20	9261547
300	26	20	9261548
350	26	20	9261549
400	26	20	9261550
450	26	20	9261551
480	26	20	9261552
500	26	20	9261553

Andere Längen und Formen können auf Anfrage gefertigt werden.

Alle Verbrennungsschiffchen können mit oder ohne Griff geliefert werden.

Other lengths and widths can be manufactured upon request.

All Combustion Boats can be manufactured with and without a handle.

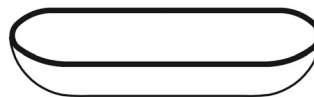

Länge mm <i>length mm</i>	Breite mm <i>breadth mm</i>	Höhe mm <i>high mm</i>	Ident-Nr. <i>Item-no.</i>
90	20	15	9788576



Länge mm <i>length mm</i>	Breite mm <i>breadth mm</i>	Höhe mm <i>high mm</i>	Ident-Nr. <i>Item-no.</i>
100	20	15	9788422

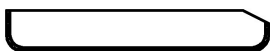

Länge mm <i>length mm</i>	Breite mm <i>breadth mm</i>	Höhe mm <i>high mm</i>	Ident-Nr. <i>Item-no.</i>
130	20	15	9788403



Länge mm <i>length mm</i>	Breite mm <i>breadth mm</i>	Höhe mm <i>high mm</i>	Ident-Nr. <i>Item-no.</i>
154	32	17	9260002

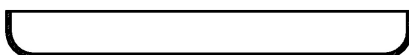

Verbrennungs- rohre Combustion Tubes

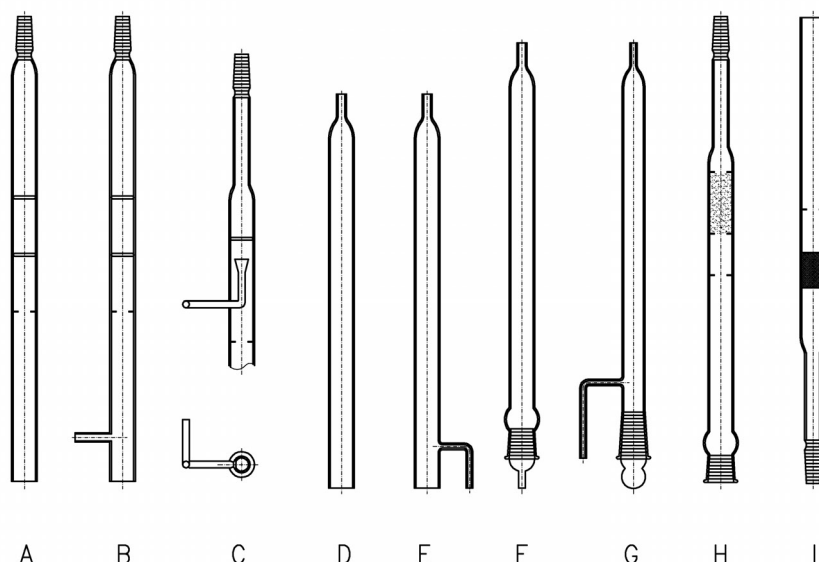

Form shape	Beschreibung description	Länge mm length mm	Ø mm	NS Kern cut	Fritten sintered discs	Ident-Nr. Item-no.
A	Makrorohre nach Grote-Krekeler <i>makro tubes Grote-Krekeler</i>	500	20	14,5	2	9782500
		550	20	14,5	2	9782501
		750	20	14,5	2	9782502
B	mit Ansatz <i>with side connection</i>	500	20	14,5	2	9782503
		433	15	10	2	9782504
C	nach Zimmermann <i>Zimmermann-Tube</i>	500	20	14,5	1	9782505
		550	20	14,5	1	9782506

Form shape	Beschreibung description	Länge mm length mm	Ø mm	Spitze mm tube mm	Ansatz mm connecion mm	Ident-Nr. Item-no.
D	mit ausgezogener Spitze <i>peak tube</i>	425	10	25x3x1	-	9782510
		450	10	25x3x1	-	9782511
		475	10	25x3x1	-	9782512
		525	10	25x3x1	-	9782513
		525	11	25x3x1	-	9782514
		700	12	25x3x1	-	9782515
E	mit ausgezogener Spitze und seitlichem Ansatz *) <i>peak tube with side connection *)</i>	525	10	25x5x1	30x30x5x2	9782516
		670	10	25x5x3	35x35x5x2	9782517
		525	11	25x5x3	35x35x5x2	9782518
		670	11	25x5x3	40x40x5x2	9782519
		525	12	25x5x3	35x35x5x2	9782520
		670	12	25x5x3	40x40x5x2	9782521

Form shape	Beschreibung description	Länge mm length mm	Ø mm	Quarz mm quartz mm	Kern/Hülse mm cone/socket mm	Ident-Nr. Item-no.
F	Makro nach Liebig	840	17	-	-	9782525
G	n. Pregel DIN 51721	840	12	-	-	9782526
H	ASTM-Conditions	500	18	1,5-2	14,5/19	9782527
		505	20	1,5-2	14,5/19	9782528
I	britische Vorschrift*) SULFOR-Analysis*)	630	18	1,5-2	19/-	9782529
		500	20	1,5-2	14,5/-	9782530

*) Verbrennungsrohre für die Schwefelbestimmung im Kraftstoff nach britischer Vorschrift I P-63/42(T).

*) Combustion tubes SULFOR-Analysis British I P-63/42(T).

Kühler Condenser

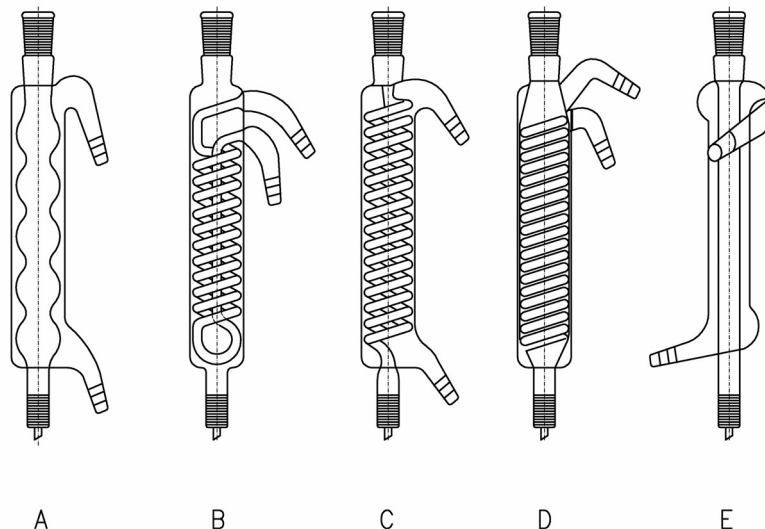

Form <i>shape</i>	Beschreibung <i>description</i>	NS	Mantellänge mm <i>jacket length mm</i>	Ident-Nr. <i>Item-no.</i>
A	Kugelkühler DIN 12581 <i>Bowl Condenser DIN 12581</i>	14,5	200	9782550
			300	9782551
			400	9782552
B	Dimrothkühler	14,5	200	9782553
			300	9782554
			400	9782555
C	Schlangenkühler <i>Twist Condenser</i>	14,5	200	9782556
			300	9782557
			400	9782558
D	Intensivkühler	14,5	200	9782559
			300	9782560
E	Liebigkühler	14,5	150	9782561
			200	9782562
			300	9782563
			400	9782564

Zusätzlich bieten wir aus Quarzglas an: *Quartz Glass-Products from the company:*

- Messpipetten · *Graduated Pipettes*
- Vollpipetten · *One-mark Pipettes*
- Gaswaschflaschen · *Gas Washing Bottles*
- Trichter · *Funnels*
- Scheidetrichter · *Separating Funnels*
- Flaschen mit NS · *Bottles with NS*
- Destillationskolben · *Distillation Flasks*
- Mehrhals-Rundkolben · *More-Neck Round Bottom*
- Messkolben · *Volumetric Flasks*
- Spitzkolben · *Pear Shape Flasks*
- Reaktionsgefäße mit Planschliffdeckel · *Reaction Vessels Flat Flange with Lid Flat Flange*
- Flanschsysteme · *Flanges-Systems*
- Kapillare · *Capillare*
- Stäbe · *Rods*
- Rohre · *Tubes*
- Spiralen · *spirals*

Sonderanfertigungen jeglicher Art aus dem Material Quarzglas in innovativer Zusammenarbeit mit unseren Kunden können jederzeit gerne angefragt werden.
Special products acc. to customer specifications on request.